

Appendix E

Groundwater Data

TABLE E-1

**VALLEY BRANCH WATERSHED DISTRICT
2013 GROUNDWATER ELEVATION DATA**

Piezometer Number	Top of Well Elevation	May 2, 2013	November 18, 2013	Average 2013
1	893.9	885.23	885.89	885.6
2	924.6	896.28	895.43	895.9
3	931.5	915.42	915.81	915.6
4	962.7	946.79	944.95	945.9
5	destroyed			
6	destroyed			
7	destroyed			
8 (1)	938.0	(2) 891.14	(2) 891.14	(3)
9	destroyed			
9A	1027.2	1017.53	1014.50	1016.0
10	964.1	931.39	(5) destroyed	(5) destroyed
11	destroyed			
12	destroyed			
13	destroyed			
14	924.2	872.07	873.49	872.8
15	destroyed			
16	877.0	838.06	839.16	838.6
17	destroyed			
18	873.1	857.07	856.11	856.6
19	destroyed			
20	994.0	905.82	906.37	906.1
21	934.9	863.00	863.77	863.4
22 (1)	889.6	(4)	(2) 853.23	(3)
23	957.2	(2) 898.71	898.76	(3)
24	903.5	879.74	880.38	880.1

(1) Data inconsistent with historical measurements. Water levels suspect.

(2) Dry well.

(3) Annual average not calculated because water elevations were below the well bottom for at least part of 2013.

(4) Flooded Well

(5) Well damaged by street reconstruction project and the installation of curb and gutter

VALLEY BRANCH WATERSHED DISTRICT

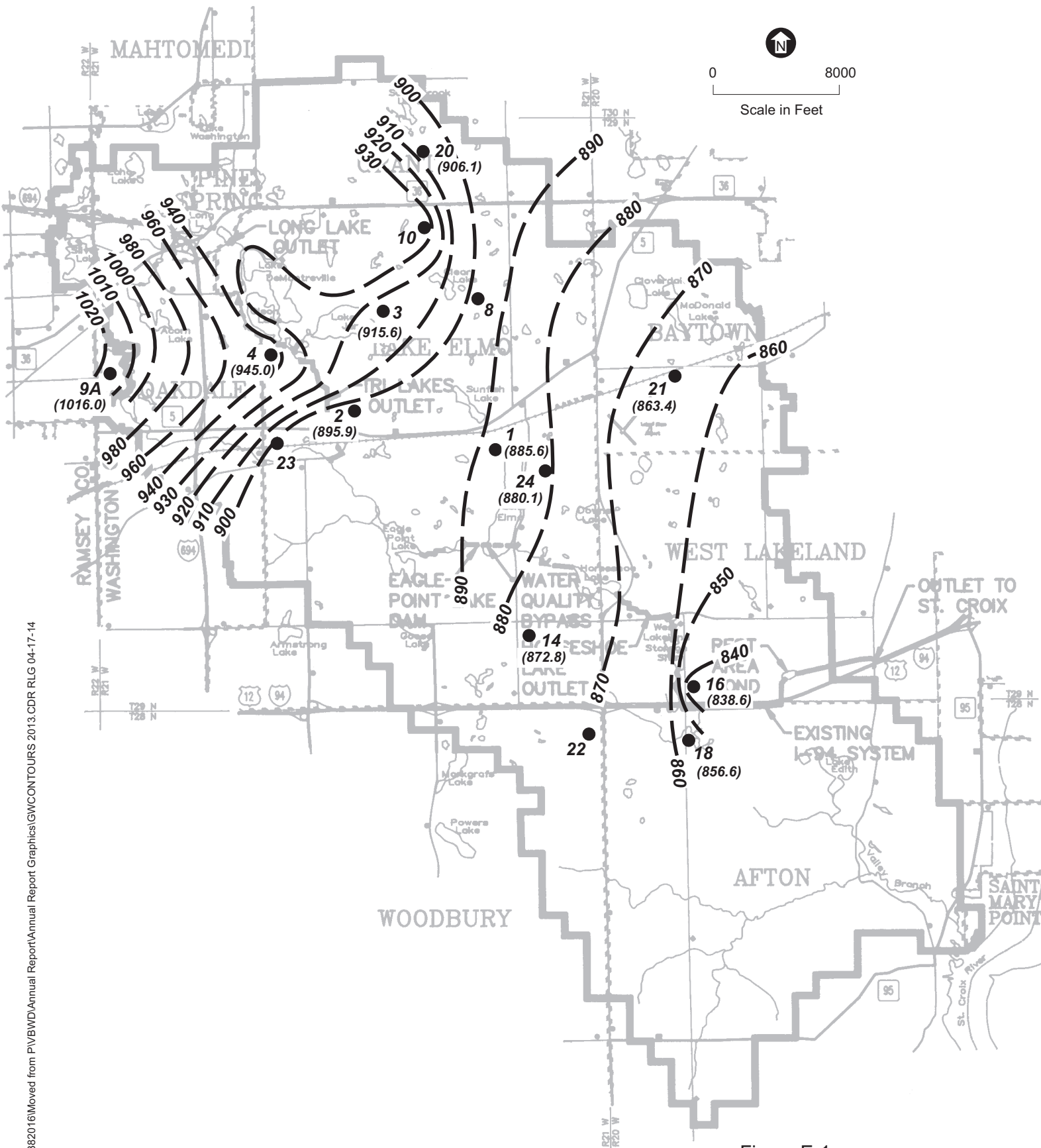

Figure E-1

GENERALIZED GROUNDWATER CONTOURS
AND WELL LOCATIONS WITH
AVERAGE WATER LEVEL
2013 GROUNDWATER LEVEL MONITORING