

Appendix E

Groundwater Observation Wells

TABLE E-1

**VALLEY BRANCH WATERSHED DISTRICT
2012 GROUNDWATER ELEVATION DATA**

| Piezometer Number | Top of Well Elevation | May 21st 2012 | November 28th 2012 | Average 2012 |
|-------------------|-----------------------|---------------|--------------------|--------------|
| 1 | 893.9 | 886.0 | 885.2 | 885.6 |
| 2 | 924.6 | 899.0 | 898.0 | 898.5 |
| 3 | 931.5 | 916.3 | 915.9 | 916.1 |
| 4 | 962.7 | 945.7 | 943.1 | 944.4 |
| 5 | destroyed | | | |
| 6 | destroyed | | | |
| 7 | destroyed | | | |
| 8 | 938.0 | 891.3 | (2) 891.14 | (3) |
| 9 | destroyed | | | |
| 9A | 1027.2 | 1016.3 | 1013.5 | 1014.9 |
| 10 | 964.1 | 932.0 | 931.7 | (1) |
| 11 | destroyed | | | |
| 12 | destroyed | | | |
| 13 | destroyed | | | |
| 14 | 924.2 | 873.7 | 873.4 | 873.5 |
| 15 | destroyed | | | |
| 16 | 877.0 | 838.9 | 837.9 | 838.4 |
| 17 | destroyed | | | |
| 18 | 873.1 | 856.9 | 857.1 | 857.0 |
| 19 | destroyed | | | |
| 20 | 994.0 | 907.4 | 906.7 | 907.1 |
| 21 | 934.9 | 865.7 | 864.3 | 865.0 |
| 22 | 889.6 | (2) 853.23 | (2) 853.23 | (3) |
| 23 | 957.2 | (2) 898.71 | (2) 898.71 | (3) |
| 24 | 903.5 | 880.9 | 879.8 | 880.4 |

(1) Data inconsistent with historical measurements. Decreasing trend in well elevation.

(2) Dry well.

(3) Annual average not calculated because water elevations were below the well bottom for at least part of 2012.

VALLEY BRANCH WATERSHED DISTRICT

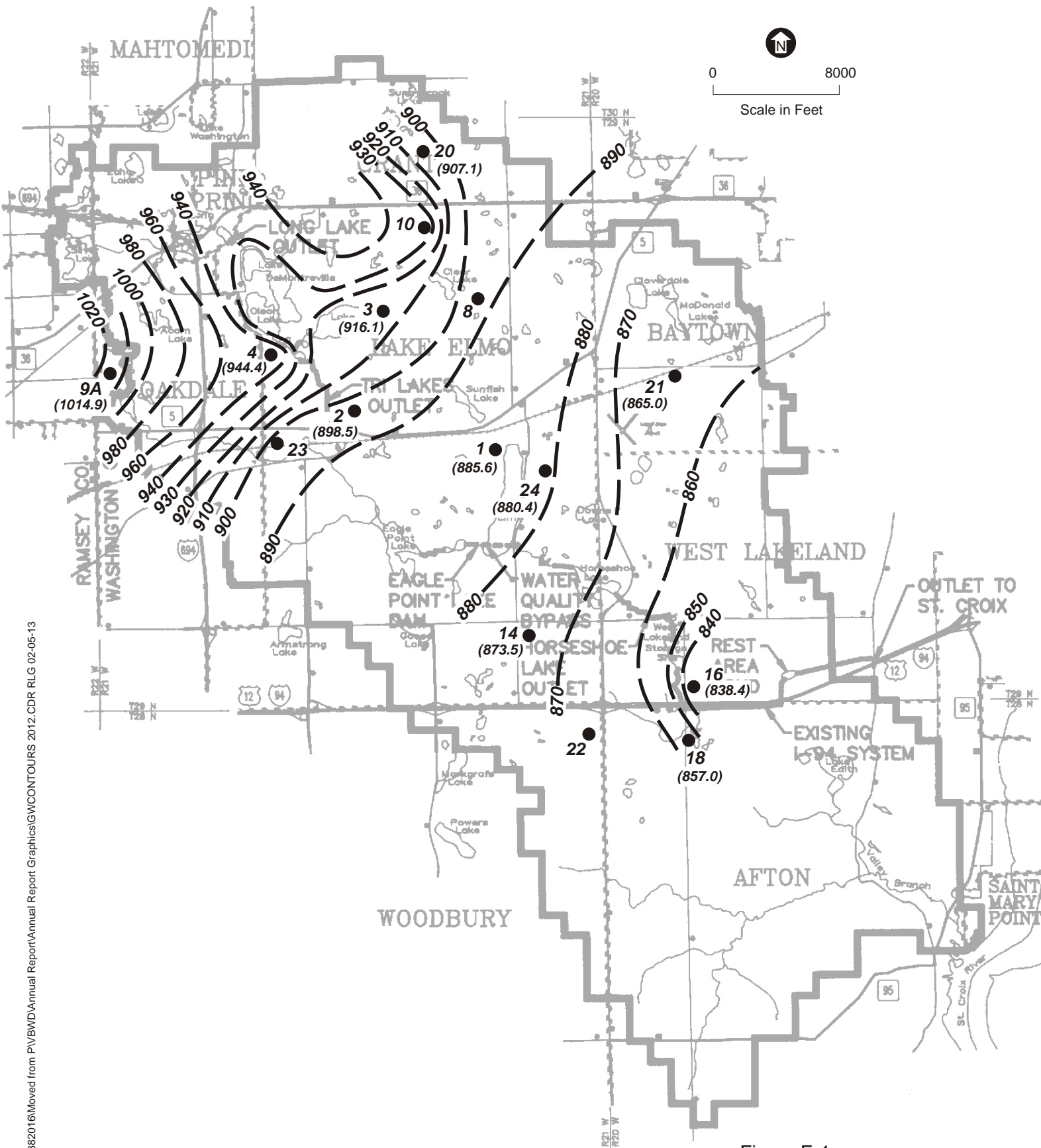

Figure E-1

GENERALIZED GROUNDWATER CONTOURS
AND WELL LOCATIONS WITH
AVERAGE WATER LEVEL
2012 GROUNDWATER LEVEL MONITORING