

## Appendix E

### Groundwater Data

**TABLE E-1**

**VALLEY BRANCH WATERSHED DISTRICT  
2013 GROUNDWATER ELEVATION DATA**

| Piezometer Number | Top of Well Elevation | May 2, 2013 | November 18, 2013 | Average 2013  |
|-------------------|-----------------------|-------------|-------------------|---------------|
| 1                 | 893.9                 | 885.23      | 885.89            | 885.6         |
| 2                 | 924.6                 | 896.28      | 895.43            | 895.9         |
| 3                 | 931.5                 | 915.42      | 915.81            | 915.6         |
| 4                 | 962.7                 | 946.79      | 944.95            | 945.9         |
| 5                 | destroyed             |             |                   |               |
| 6                 | destroyed             |             |                   |               |
| 7                 | destroyed             |             |                   |               |
| 8 (1)             | 938.0                 | (2) 891.14  | (2) 891.14        | (3)           |
| 9                 | destroyed             |             |                   |               |
| 9A                | 1027.2                | 1017.53     | 1014.50           | 1016.0        |
| 10                | 964.1                 | 931.39      | (5) destroyed     | (5) destroyed |
| 11                | destroyed             |             |                   |               |
| 12                | destroyed             |             |                   |               |
| 13                | destroyed             |             |                   |               |
| 14                | 924.2                 | 872.07      | 873.49            | 872.8         |
| 15                | destroyed             |             |                   |               |
| 16                | 877.0                 | 838.06      | 839.16            | 838.6         |
| 17                | destroyed             |             |                   |               |
| 18                | 873.1                 | 857.07      | 856.11            | 856.6         |
| 19                | destroyed             |             |                   |               |
| 20                | 994.0                 | 905.82      | 906.37            | 906.1         |
| 21                | 934.9                 | 863.00      | 863.77            | 863.4         |
| 22 (1)            | 889.6                 | (4)         | (2) 853.23        | (3)           |
| 23                | 957.2                 | (2) 898.71  | 898.76            | (3)           |
| 24                | 903.5                 | 879.74      | 880.38            | 880.1         |

(1) Data inconsistent with historical measurements. Water levels suspect.

(2) Dry well.

(3) Annual average not calculated because water elevations were below the well bottom for at least part of 2013.

(4) Flooded Well

(5) Well damaged by street reconstruction project and the installation of curb and gutter

# VALLEY BRANCH WATERSHED DISTRICT

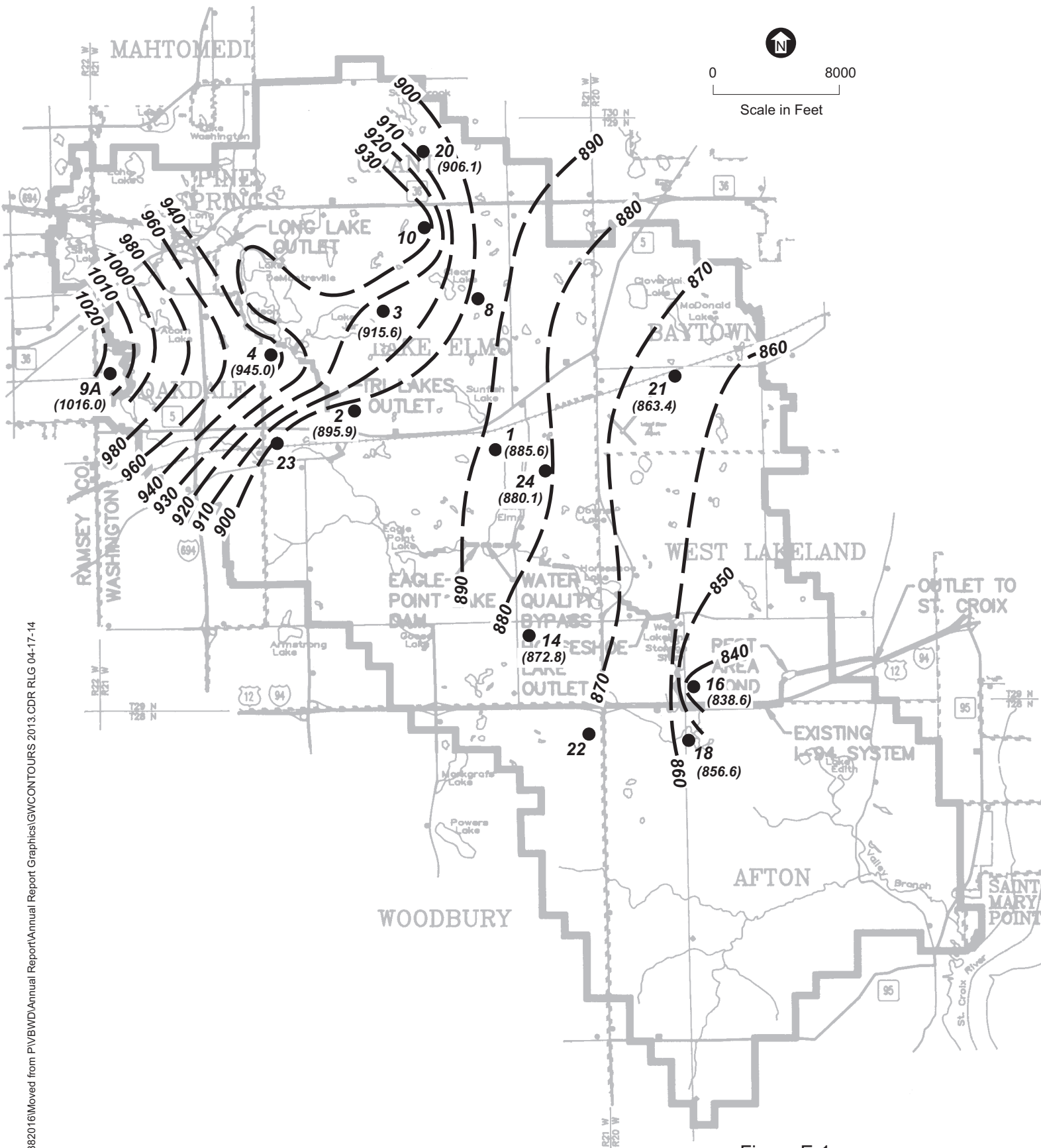

Figure E-1

GENERALIZED GROUNDWATER CONTOURS  
AND WELL LOCATIONS WITH  
AVERAGE WATER LEVEL  
2013 GROUNDWATER LEVEL MONITORING