

Appendix E

Groundwater Observation Wells

TABLE E-1

**VALLEY BRANCH WATERSHED DISTRICT
2012 GROUNDWATER ELEVATION DATA**

Piezometer Number	Top of Well Elevation	May 21st 2012	November 28th 2012	Average 2012
1	893.9	886.0	885.2	885.6
2	924.6	899.0	898.0	898.5
3	931.5	916.3	915.9	916.1
4	962.7	945.7	943.1	944.4
5	destroyed			
6	destroyed			
7	destroyed			
8	938.0	891.3	(2) 891.14	(3)
9	destroyed			
9A	1027.2	1016.3	1013.5	1014.9
10	964.1	932.0	931.7	(1)
11	destroyed			
12	destroyed			
13	destroyed			
14	924.2	873.7	873.4	873.5
15	destroyed			
16	877.0	838.9	837.9	838.4
17	destroyed			
18	873.1	856.9	857.1	857.0
19	destroyed			
20	994.0	907.4	906.7	907.1
21	934.9	865.7	864.3	865.0
22	889.6	(2) 853.23	(2) 853.23	(3)
23	957.2	(2) 898.71	(2) 898.71	(3)
24	903.5	880.9	879.8	880.4

(1) Data inconsistent with historical measurements. Decreasing trend in well elevation.

(2) Dry well.

(3) Annual average not calculated because water elevations were below the well bottom for at least part of 2012.

VALLEY BRANCH WATERSHED DISTRICT

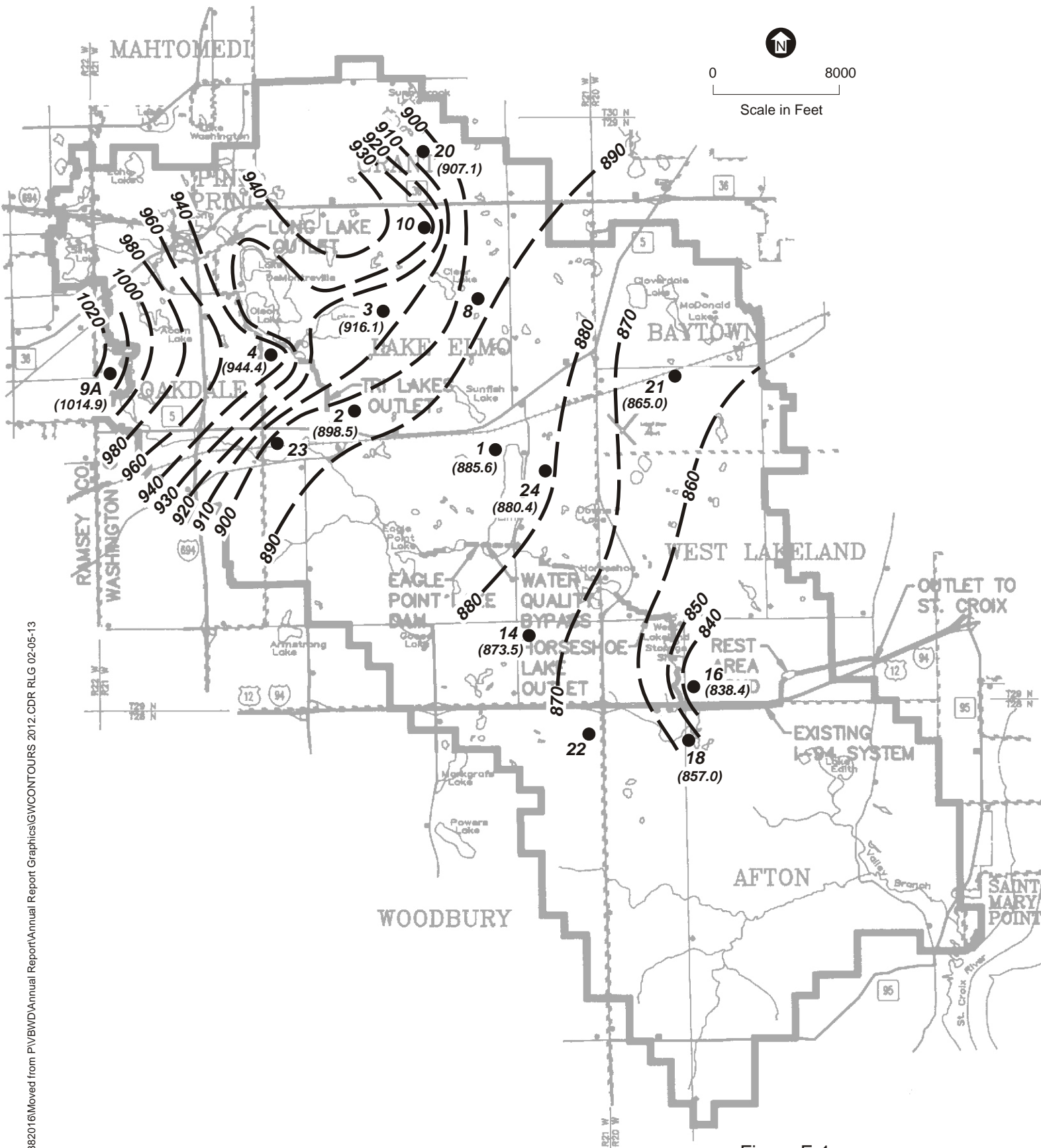

Figure E-1

GENERALIZED GROUNDWATER CONTOURS
AND WELL LOCATIONS WITH
AVERAGE WATER LEVEL
2012 GROUNDWATER LEVEL MONITORING